



Useful Knots

Round Turn and Two Half Hitches

- Used for tying up boats
- Easy to break

Round Turn and Two Half Hitches Tying Instructions

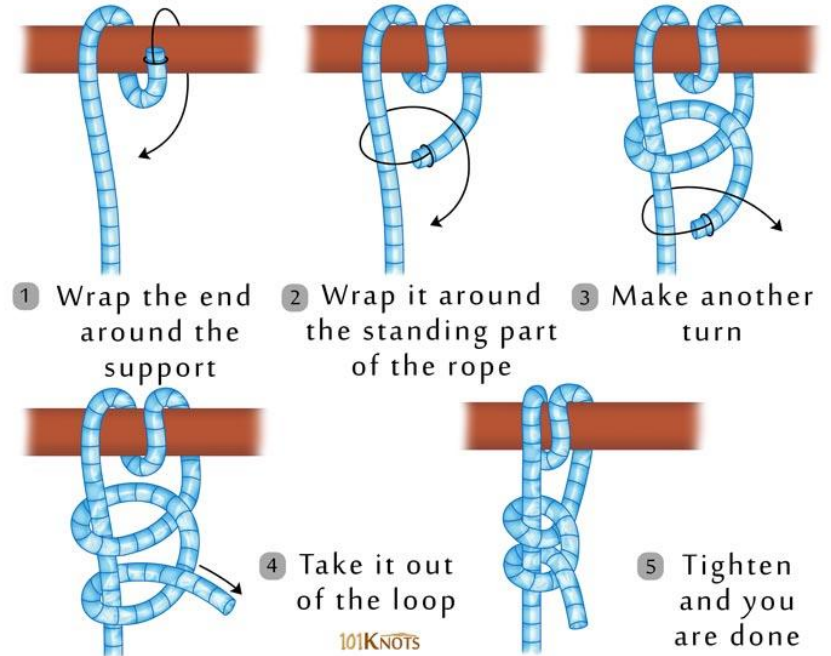

Bowline

- Non-slip loop
- Strong load
- Easy to break

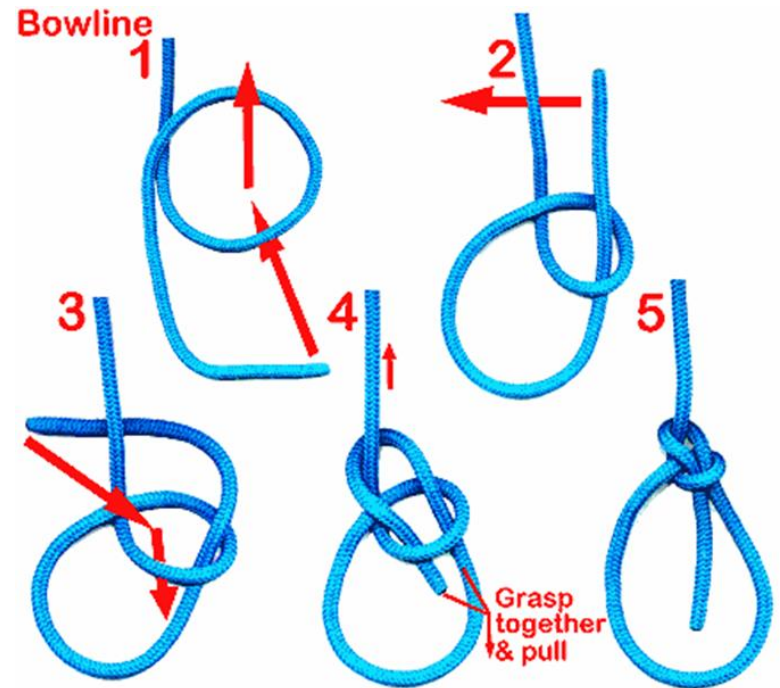

Rolling Hitch

- Grips in one direction, slides in other
- More secure than Clove Hitch
- Strong load
- Easy to break
- Herringbone tow is useful application
 - Wind twice towards tail of tow, then
 - Capture the turns by going back up once

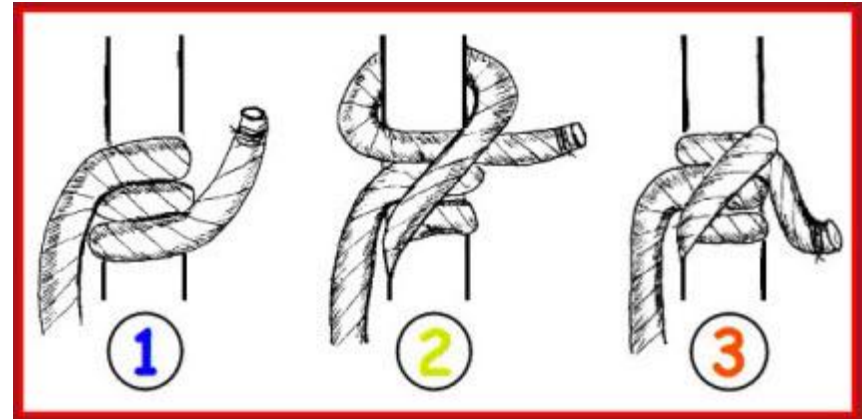

How to Tie the Clove Hitch Knot

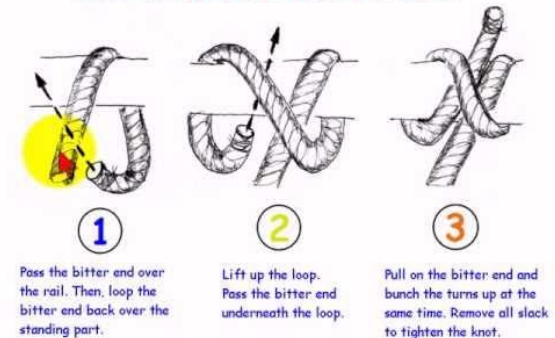

Double Sheet Bend

- Linking two ropes of different diameter
- More secure than Sheet Bend
- Strong load
- Easy to break

Double Sheet Bend Instructions

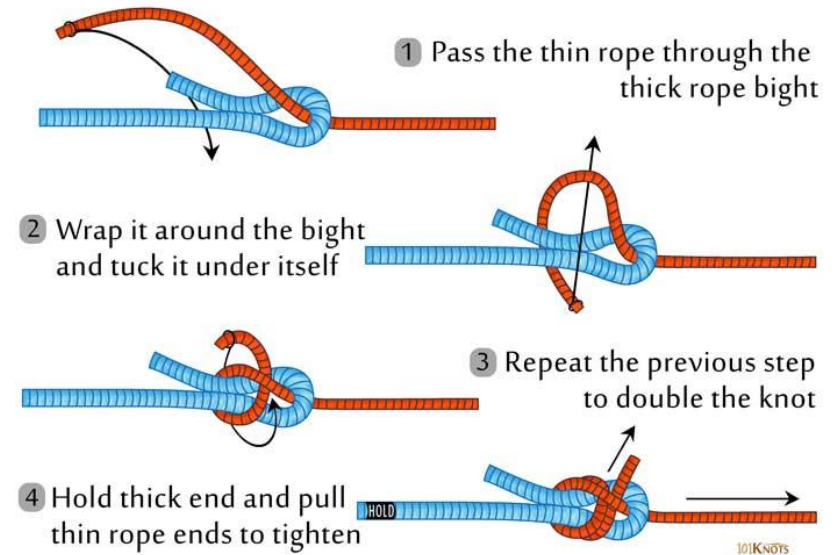

Sheet Bend Step By Step

